

oakfull 澳可富

OAKFULL RO-150

(Hereinafter referred to as RO)

Non-Electric Reverse Osmosis Water Purifier



User Manual

1. Operating parameters.....	3
2. Product Assembly.....	4
3. Product Composition and Filter Introduction.....	5
4. Installing the Reverse Osmosis Water Purifier.....	6
5. Starting the RO System.....	10
6. Warranty.....	14
7. Troubleshooting.....	16

Warning

Please read this manual carefully before starting installation. Failure to follow any accompanying instructions or operating parameters may lead to product malfunction and possible property damage.

Keep this manual for future reference.

Thank you for purchasing this Oakfull Non-Electric Reverse Osmosis Water Purifier. With correct installation and maintenance, this product will provide you with high-quality drinking water. The technology used in Oakfull RO allows for the controlled remineralization of the filtered water. If you have any questions or concerns, please contact our customer service department: Tel +86 (532) 8997 5888, or email sales@oakfull.cn. We are always happy to answer any questions about our products.

Introduction

Oakfull RO works by removing contaminants from water at the molecular level. It utilizes your home's water pressure to force water through the RO membrane, separating water molecules from impurities. Trapped dissolved solids are automatically flushed away through the drain line, leaving only high-quality, great-tasting pure water for your use.

1. Operating parameters

Product Name	Non-Electric Reverse Osmosis Water Purifier	
Product Model	OAKFULL RO-150	
Rated Total Net Production	5000 L	
Water Source	Municipal Tap Water	
Production Speed	0.5 L/min	
Maximum Output Flow Rate	2.5 L/min	
Operating Temperature	Max 38 °C (100.4 °F)	Mini 5 °C (41 °F)
Operating Pressure	Max 6 kg	Mini 2.5 kg
Dimensions (L x H x W)	362 x 415 x 190 mm	

* The efficiency of the RO membrane depends on the Total Dissolved Solids (TDS) and water pressure of the incoming water. The RO device requires a tap water pressure of no less than 0.25 MPa. If the tap water pressure is below 0.25 MPa, it is recommended to install a booster pump.

Safety Instruction

- **Warning: The RO system is intended for drinking water only.**
- It is recommended that installation and maintenance of this equipment be carried out by a professional.
- Before installing the device, test the quality of the tap water. If the tap water quality does not meet the installation requirements, the filter cartridge lifespan will be significantly shortened. In this case, using an auxiliary water treatment system (such as a pre-filter, water softener, etc.) is recommended to prevent substandard water from reducing filter life.
- Ensure the water source is municipal tap water; other water sources cannot meet installation requirements.
- Copper pipes should not be used to deliver filtered pure water, as pure water may leach copper, affecting taste and safety.
- The device must only be connected to a cold water faucet valve. The water temperature should be between 5°C and 38°C.

2. Product Assembly

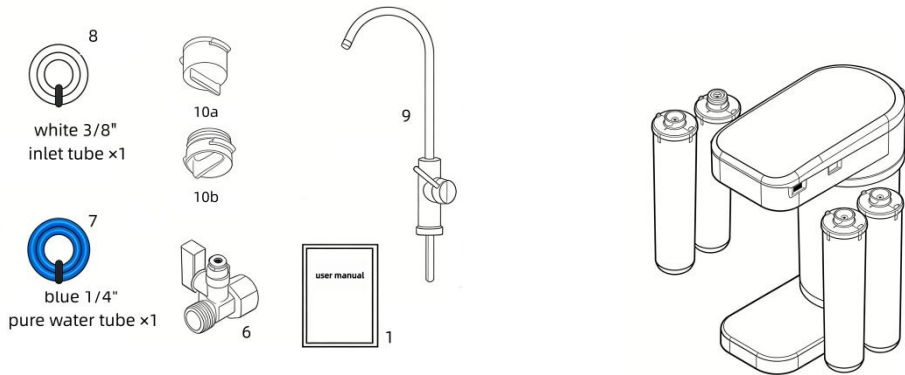

Figure 1. Product Assembly Diagram

Name	Quantity
OAKFULL RO100/150	1
PP Filter Cartridge	1
CB1 Filter Cartridge	1
RO-150 Filter Cartridge	1
CB2 Filter Cartridge	1
Three-Way Valve	1
Purified Water Faucet Set	1
White CCK Tube 3/8"	1m
Blue CCK Tube 1/4"	3m
PP/CB1/CB2 Plugs (located under the top cover)	3
RO Plug (located under the top cover)	1
User Manual (including Warranty Card and Certificate of Conformity)	1

3. Product Composition and Filter Introduction



图3.RO主要组件

1 – RO Housing Assembly; 2 - CB1; 3 - PP; 4 - RO; 5 - CB2; 6- Water Storage Tank

1. The RO device consists of an upper waterway plate, a water storage tank, and 4 filter cartridges; the upper plate is equipped with a decorative cover and fixed with two plastic parts. The storage tank stores filtered pure water to ensure flow rate when the tap is opened. Tap water is pre-treated by PP (3) and CB1 (2) before passing through the RO membrane (4): the PP filter intercepts large particles, and CB1 adsorbs residual chlorine, effectively extending the life of the RO membrane.
2. The selected RO membrane (4) is a low-pressure reverse osmosis membrane with a high desalination rate and lasting effect, ensuring the filtered water meets direct drinking standards.
3. The CB2 post-activated carbon cartridge further adsorbs any residual chlorine that may remain after RO membrane filtration, improving the taste of the output water.

4. Installing the Reverse Osmosis Water Purifier

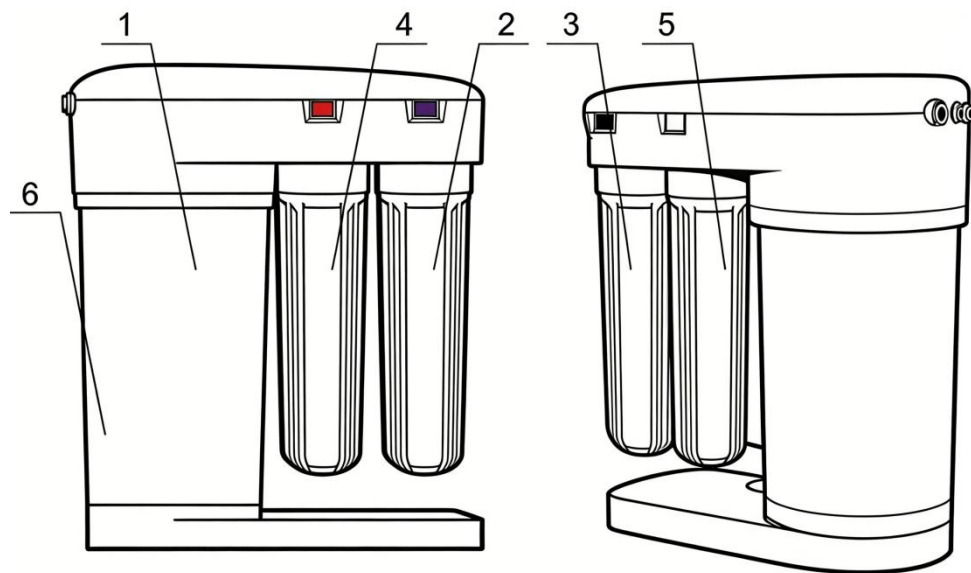
- Special Reminder: It is recommended that a professional installs the water purifier.

- How to open the top cover?
Rotate the two plastic locking screws on the top cover 90 degrees counterclockwise.

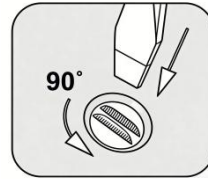

- The water purifier needs to be installed in a suitable, dry location. Additionally, the purifier must be kept away from heat sources such as kitchen ovens, hot water supply pipes, dishwashers, or washing machines, or at least isolated from these heat sources. The incoming water must be cold water. Caution! Ensure that the connected PE tube is not excessively bent to guarantee smooth water inlet and outlet. The water purifier must be installed on a flat, sturdy surface. Installing on an uneven surface may cause vibration or noise.

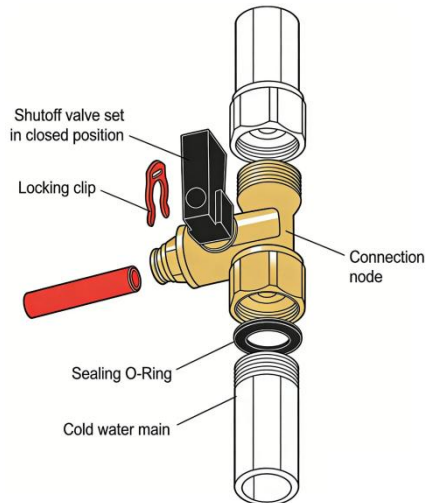



图 4.RO 无电净水器安装示意图

Connecting Node Components

1. Close the cold water valve.
 2. Open the kitchen faucet to release pressure.
 3. Install the three-way valve on the cold water pipe.
- Caution! Ensure the O-ring is correctly installed and not damaged during installation.

Connecting PE Tubes

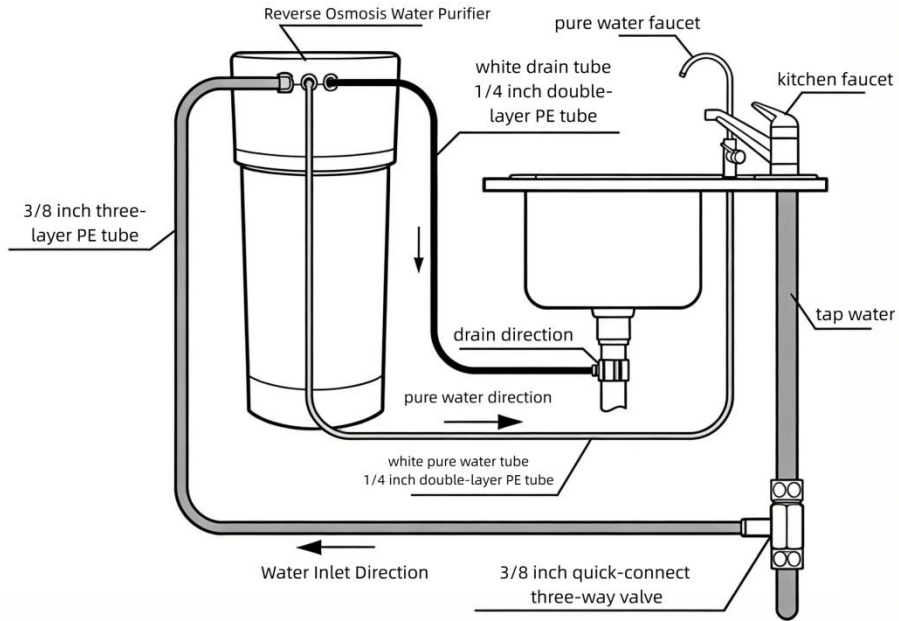
Insert the pre-moistened tube end (3) into the connector fitting approximately 15 mm until it bottoms out. Then, install the blue quick-connect fitting (2) into the middle connection position. Ensure the tube (3) is correctly locked: the tube should not be pull-out-able with a force of 8-10 kg.

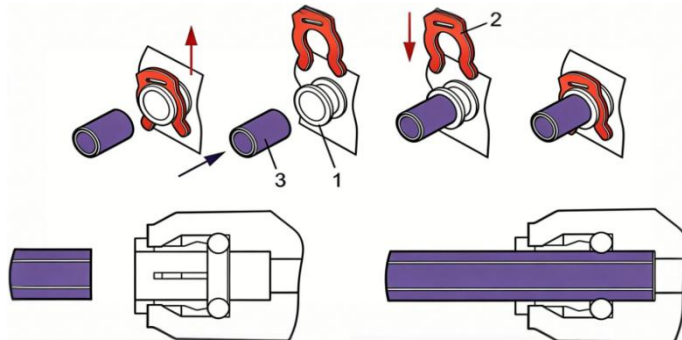

Figure 6. Connecting PE Tubes

Disconnecting PE Tubes

Pull out the blue quick-connect fitting (2) from the plastic plug (1), then remove the tube (3) by pressing on the end face of the connector.

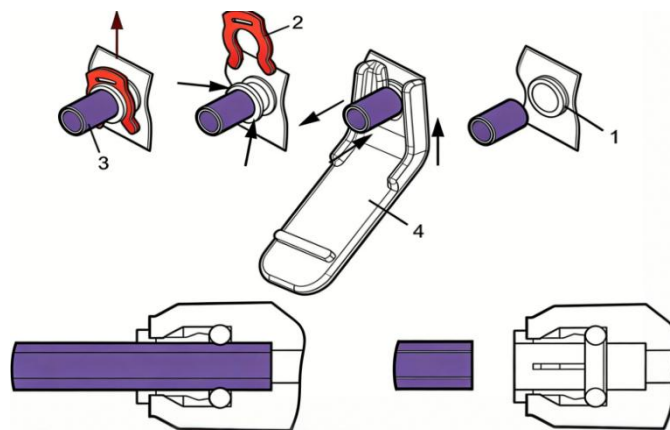

Figure 7. Disconnecting JG Tube

Installing the Purified Water Faucet

1. Drill a hole with a diameter of 12 mm in the sink (countertop).
2. Slide the rubber gasket (2), decorative base (3), and rubber gasket (4) sequentially onto the threaded tail of the faucet (11), then insert the faucet into the hole in the sink.
3. Below the sink, slide the plastic (5) and metal (6) locking washers onto the threaded bushing, then screw on the tightening nut (7).
4. Slide the locking nut (9) onto the plastic tube (10) with the pressed-in metal bushing (8) (Fig. 8), then screw the nut onto the tail of the faucet.

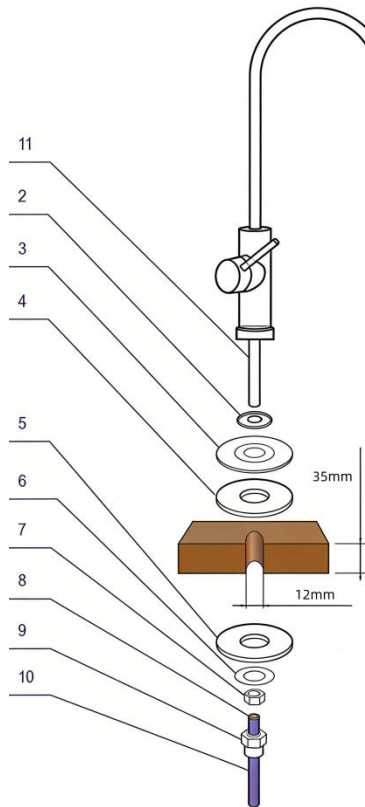

Figure 8. Purified Water Faucet Connection Tube Steps

5. Starting the RO System

To start the RO system, you must connect the water inlet pipe and perform the flushing procedure for the filter cartridges and the membrane element.

Step 1. Connect the water inlet pipe according to the diagram below(Figure 11).See Figure 6 for tube connection diagram

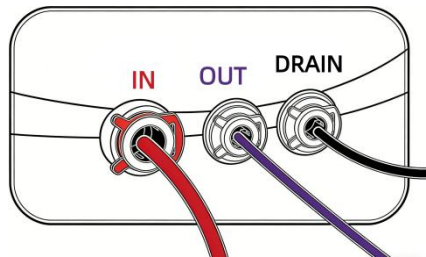

Figure 11. Water Inlet Pipe Connection

Step 2. Prepare the RO System for Operation

- Rotate the latches 90 degrees counterclockwise and remove the top cover of the water purifier (Figure 2).
- Remove the service cover located under the top cover of the water purifier (Fig. 1; pos. 10b).
- Remove the shrink wrap from the filter cartridges.
- Flush the filter cartridges and the sealing O-rings of the service cover.
- Arrange the filter cartridges strictly in the order shown in Table 2. For convenience, the locking buttons on the cartridges are different colors.
- Set the shut-off valve on the connection node to the open position, as shown in Figure 4.
- Leave the purified water faucet open for 10 minutes.
- **Noise during filter flushing is not a malfunction.**
- Close the purified water faucet.

● Button Color	● Button Color
● Green	● PP
● Orange	● CB1
● Blue	● RO-150
● Purple	● CB2

Step 3. Flush the RO Membrane Element

- Set the shut-off valve on the connection node to the closed position, as shown in Figure 5.
- Remove the service plug and install the RO membrane cartridge.
- Swap the positions of the PP and CB1 filter cartridges.
- Rotate the shut-off valve on the connection node to the open position.
- Open the purified water faucet and wait for the water flow to start.
- Let the water flow through the RO system to flush for 1 hour. Close the purified water faucet.

Step 4. Flush the Post-Carbon Filter CB2

- Close the purified water faucet and allow the storage tank to fill with water. Depending on water pressure, this takes 30-50 minutes.
- Open the purified water faucet and wait until all water has flowed out of the storage tank.
- Repeat these steps two more times.
- Close the purified water faucet.
- When the storage tank is full, the RO system is ready for operation.

Note: The total flushing and start-up time for the filter cartridges and RO membrane element is approximately 3 hours.

* Depending on storage, transport, and operating conditions, complete flushing of the RO membrane element may take up to 24 hours.

The service life of the RO membrane element directly depends on the operation of the pre-treatment water treatment units. Therefore, it is always important to replace filter cartridges in a timely manner.

Replacing PP and CB1 Filters (Figure 12)

- Close the water inlet valve and open the purified water faucet to release pressure.
- Press the locking button while turning clockwise to remove the filter cartridge.
- Replace with a new PP or CB1 filter cartridge.

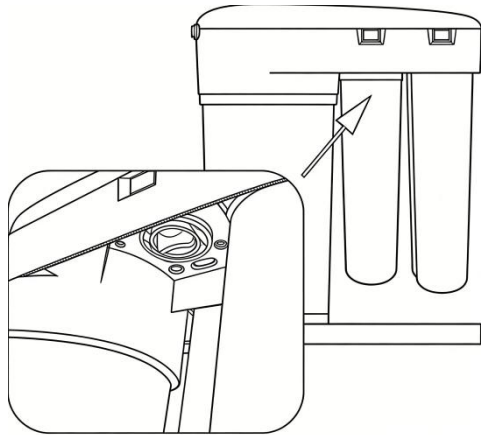

Notes:

1. The steps for replacing CB2 and RO membrane cartridges are the same as for replacing PP and CB1 cartridges.
2. To ensure correct installation when replacing filter cartridges, please contact your local service provider or the national customer service hotline for consultation. If leakage occurs due to improper sealing, immediately close the three-way valve of the water purifier.

* Filter cartridges are consumables. Once used, they are non-returnable and non-refundable due to quality issues.

** Depending on storage, transport, and operating conditions, complete flushing of the RO membrane element may take up to 24 hours.

Note: Installing the RO device on a source that has been pre-treated will significantly extend the life of its filter cartridges

Table 3. Recommended Filter Replacement Schedule

The replacement schedule for filter cartridges depends on water quality. Using this device in a system with pre-treatment (pre-filters, water softeners, etc.) can significantly extend the service life of the cartridges.

Filter	Recommended Replacement Period (Months)
PP	6-12
CB1	12-24
RO	36-60
CB2	12-24

The storage period for replacement cartridges is three years. The frequency of replacement depends mainly on the quality of the water entering the device. Note: Reduced output flow or slower flow rate may be due to not replacing filter cartridges. Warning: The water inlet valve must be closed before performing any filter cartridge replacement operation.

PP Filter: Filtration precision 1-5 microns.

CB1 Pre-Carbon Filter: Removes organic matter and free chlorine from water, protecting the RO membrane from oxidation by free chlorine. Replacement frequency should be determined based on the free chlorine content in the water.

RO Reverse Osmosis Filter: The RO membrane removes most dissolved solids and colloidal substances from the water; separated substances are discharged into the drain with the concentrated water. The RO membrane is key to reducing the TDS value of tap water.

CB2 Post-Carbon Block Filter: Further adsorbs residual chlorine not filtered out by the RO membrane, improving the taste of the pure water.

6. Warranty

The installation, operation, storage, and transportation rules described in this manual must be observed.

The manufacturer is not responsible for the operation of the Oakfull RO system and possible consequences in the following cases.

The RO system or its components show obvious mechanical, thermal, or chemical damage.

The RO installation and operation requirements described in this manual have not been fulfilled.

The service life of RO system components is:

RO Housing -- 5 years from the date of manufacture*;

Connection Tubes -- 3 years from the date of manufacture*;

Purified Water Faucet -- 3 years from the date of manufacture*

The service life (capacity) of replacement filter cartridges is:

Replacement Filter Name	Service Life
PP	6 -12 months
CB1	1 -2 years
OAKFULL RO-150	3-5 years
CB2	1 -2 years

The above data is based on an average daily pure water consumption of 10 liters.

Attention!

* Regardless of the operation start date.

** The service life (capacity) of replacement filter cartridges may depend on the quality of the incoming water. If the source water contains a large amount of insoluble impurities, the PP and CB1 cartridges should be replaced after 6-12 months of operation.

*** The life of the RO membrane element depends on the efficiency of the pre-filtration and water conditioning units.

Please replace filter cartridges timely.

The warranty period for the operation of the RO system (excluding replacement filter cartridges and the RO membrane element) is 2 years from the date of purchase.

The storage period for the RO system before operation is a maximum of 3 years, under the condition of storage at temperatures between +5 and +38°C (40 to 100 °F) and in its original undamaged packaging.

If you have any questions about the operation of the RO system, please contact the seller or manufacturer.

The manufacturer is not responsible for operational malfunctions caused by improper installation or maintenance.

The manufacturer is not responsible for operational malfunctions caused by improper replacement of filter cartridges.

The warranty is only valid if the instructions are followed and only unexpired filter cartridges are used. Failure to replace filter cartridges timely or follow installation/maintenance instructions will void the warranty.

7. Troubleshooting

If the device is operating with difficulty, use the device's shut-off valve to close the water supply to the device.

Problem	Possible Cause	Solution
Faucet output flow is very slow.	Three-way valve not fully opened.	Fully open the three-way valve and faucet.
Faucet output is slow or no water.	A filter cartridge needs replacement.	Check which filter needs replacement based on its service life and replace it. To determine which cartridge needs replacing, follow these instructions
Storage tank fills slowly or not at all.	<ul style="list-style-type: none"> — Close the shut-off valve and open the faucet to release pressure. — Replace the PP, CB1, and CB2 cartridges with the filter plugs (located under the cover). — Open the three-way valve. — Open the faucet and flush the water from the device until the flow decreases and the tank empties. If the water flow remains faster than 50 ml/min, install the CB2, PP, and CB1 cartridges one by one and determine which cartridge(s) needs replacing based on the decrease in flow. If the water flow is slower than 50 ml/min, the membrane needs replacing. When replacing any filter, close the three-way valve, and open it after the replacement is complete. 	
<p>If other faults are found, please contact our customer service department at +86 (532) 8997 5888, or email sales@oakfull.</p>		

After-Sales Service

1. Warranty Period

The warranty period is calculated from the date of purchase by the customer. The complete unit is warranted for two years.

2. Warranty Conditions

Users must purchase the product through legal channels from authorized retailers.

Users must keep the invoice and user manual safely.

Installation of the product must strictly follow the instructions in the manual. Installation should be carried out by professional installers designated by the manufacturer or installers certified by nationally recognized authorities. Professional installation is recommended.

Use of the product must strictly comply with the user manual. Users must ensure the product is used under normal operating conditions.

If maintenance and care are needed during use, please contact the designated professional service provider.

3. The following situations are not covered by the warranty

- Products obtained through illegal means or channels.
- Products lacking necessary documentation such as invoice, user manual, warranty card, or other relevant proof materials.
- Failure or damage caused by not following the product manual for installation, or self-installation without factory guidance.
- Failure or damage resulting from unreasonable use or violation of the stipulations in the Installation and Operation Manual.
- Failure or damage caused by using the product outside normal operating conditions (e.g., water pressure too low or too high).
- Machine damage caused by human factors (intentional or unintentional).

- Machine damage caused by force majeure (e.g., natural disasters, war, etc.).
- Machines repaired by unauthorized professionals.

4. Warranty Service

During the warranty period, if the product meets the warranty conditions and does not violate the exception clauses, when the product malfunctions or is damaged, our company will provide comprehensive warranty service according to regulations, including:

- (1) Free repair of the faulty machine.
- (2) Free replacement of faulty parts.
- (3) Other items stipulated by national regulations (including the Consumer Protection Law, Product Quality Law).

5. Warranty Service Process

If users discover a malfunction while using our company's product, please shut off the water source immediately. Contact the service provider from the purchase channel within 24 hours, and provide relevant product warranty service materials at the same time.

When the maintenance personnel arrive on-site for service, the user must present a valid invoice and other relevant product warranty service materials, and explain the usage situation and fault status to the service personnel. After verifying the machine, the service personnel will carry out the corresponding inspection and repair work.

Warranty Card OAKFULL RO

Serial Number#

Warranty PIN Code

Date of Sale

Seller's Stamp

Seller's Signature